

7. Exploded View & Parts List

7-1 HLN5065WX/XAC

You can search for the updated part code through ITSELF web site.
URL : <http://itself.sec.samsung.co.kr>

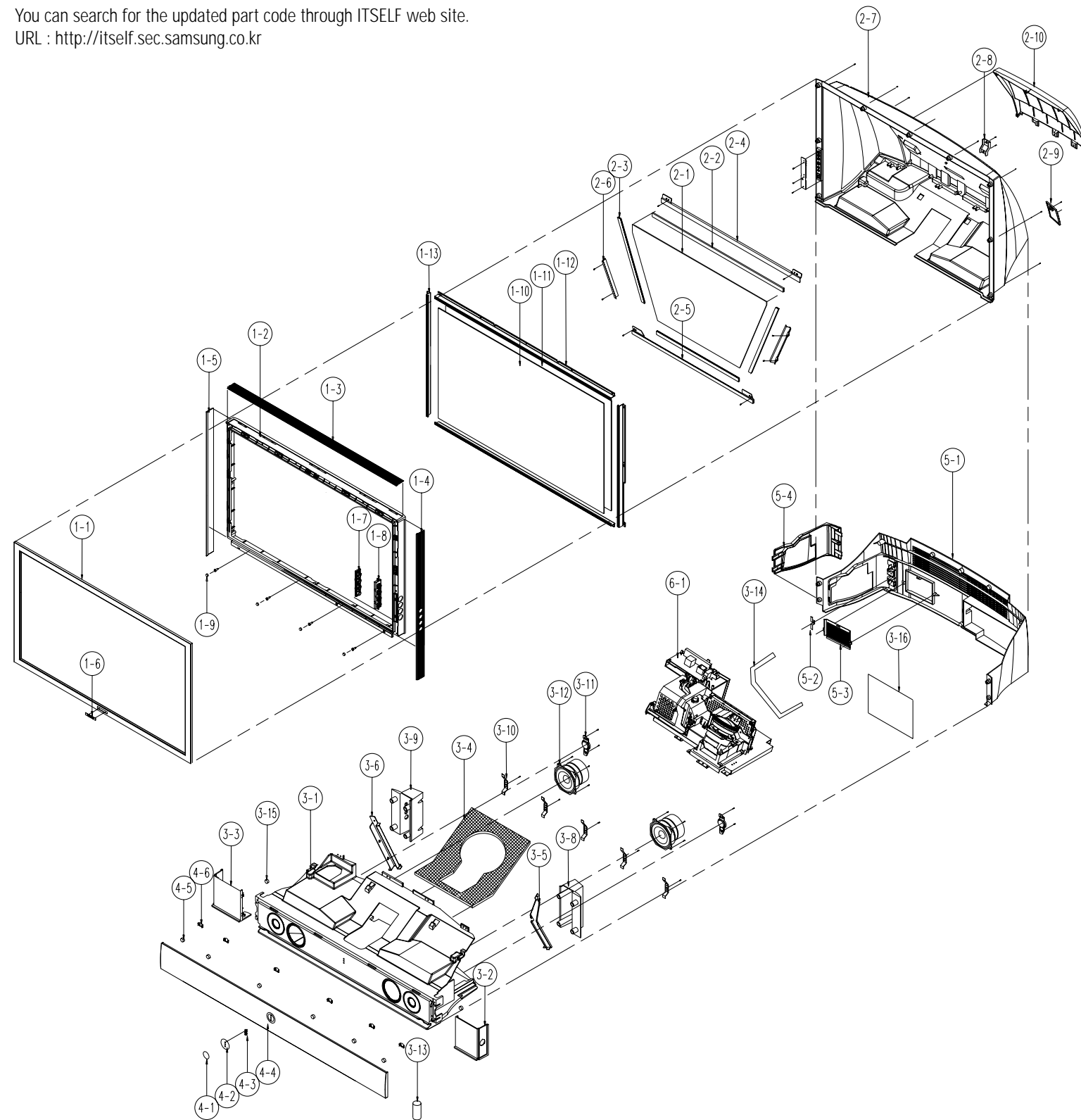

No	Code No	Description	Specification	Q'ty	S.N.A
1-1	AA64-01789P	CABINET FRONT;50L2,HIPS,HB,G4309,SV012P+		1	
1-2	AA64-01790B	CABINET-MIDDLE;50L2,HIPS,HB,G4309,SV-012		1	
1-3	BP63-00032A	COVER-DECO, TOP;50L2,ABS,HB,BLK,SVM-4704P		1	S.N.A
1-4	BP63-00034A	COVER-DECO,L;50L2,ABS,HB,BLK,SVM-4704P,		1	S.N.A
1-5	BP63-00036A	COVER-DECO,R;50L2,ABS,HB,BLK,SVM-4704P,		1	S.N.A
1-6	BP64-00177A	BADGE-BRAND;ALL,AL,T1.5,70,11.3,.,BLK,SIL		1	S.N.A
1-7	AA64-01793B	KNOB-FAMILY;43L2,ABS,HB,G3676,SVM-3012		1	
1-8	AA64-01794B	KNOB-HOLDER;43L2,ABS,HB,G3676,VACCUM PLA		1	
1-9	AA67-00169A	SCREEN LENTI;LENTICUALR,50W,MS,1128*647,		1	
1-10	AA67-00172A	SCREEN FRESNEL;50W,MS,1128*647,T1.35,P5		1	
1-11	AA61-01138A	BRACKET-SCREEN, TOP;50,AL6063 EXTR,BLK		2	S.N.A
1-12	AA61-01139A	BRACKET-SCREEN, SIDE;50,AL6063 EXTR,BLK		2	S.N.A
2-1	BP67-00041A	MIRROR-FRONT,DM1;50,GLASS,922*547*512*3		1	
2-2	AA63-00021K	SPACER-MIRROR;50J6,PVC,BLK,HB L500		3	S.N.A
2-3	AA63-00021E	SPACER-MIRROR;SP-434JMF,PVC,-,-,-,BLK,-,		1	S.N.A
2-4	AA61-00443B	BRACKET-MIRROR, TOP;ST-50J6,SECC,T1.6,-,-		1	S.N.A
2-5	AA61-00445B	BRACKET-MIRROR, BOT;ST-50J6,SECC,T1.6,-,-		1	S.N.A
2-6	AA61-00444B	BRACKET-MIRROR, SIDE;ST-50J6,SECC,T1.6,-,-		2	S.N.A
2-7	AA64-00698B	CABINET-BACK, TOP;50J6,HIPS,VO,GRY,G4309		1	
2-8	AA63-00212C	COVER-CONNECTOR;,HIPS,VO,GRAY G4309		1	S.N.A
2-9	AA63-00196C	COVER-DUST;50J6,HIPS,VO,GRAY G4309		1	S.N.A
2-10	AA63-00599A	COVER-BACK;507W,HIPS,VO,GRY,G4309		1	
3-1	AA64-00548D	CABINET-MAIN;43J6,HIPS,VO,GRY		1	S.N.A
3-2	BP61-00082A	HOLDER-FRONT,RIGHT;507W,HIPS HB,GRAY		1	S.N.A
3-3	BP61-00083A	HOLDER-FRONT,LEFT;507W,HIPS HB,GRAY		1	S.N.A
3-4	AA60-00033B	SPACER-LENS;43J6,P/U-FOAM V0 D45,BLK,T3.		1	S.N.A
3-5	AA61-00853B	BRACKET-SUPPORT,L;50J6,SECC-1,T1.6,NTR		1	S.N.A
3-6	AA61-01202A	BRACKET-SUPPORT;507W,SECC-1,T1.6,NTR		1	S.N.A
3-7	BP61-00084A	HOLDER-BACK,RIGHT;507W,HIPS VO,GRAY		1	S.N.A
3-8	BP61-00085A	HOLDER-BACK,LEFT;507W,HIPS VO,GRAY		1	S.N.A
3-9	AA61-00165B	BRACKET-GRILLE;43J6,SECC-1,T1.0,-,-,BLK,		4	S.N.A
3-10	3001-001144	SPEAKER;25W,70HM,88DB,1.6KHZ		2	
3-11	3001-001282	SPEAKER;25W,80HM,90DB,55HZ		2	
3-12	AA63-60117A	SPACER-FOOT;SVP403J,NEOPRENE,-,-,-,BLK,-		2	S.N.A
3-13	AA61-01203A	BRACKET-SUPPORT,BACK;507W,SECC-1,T1.6,BL		1	S.N.A
3-14	AA61-00678B	HOLDER-BOSS;43/50L2,HIPS,NTR,HB		2	S.N.A
3-15	BP96-00082A	ASSY COVER P-TERMINAL BOARD;HLM507W,HIPS		1	
4-1	BP64-00096E	WINDOW-LED;507W,ACRLY,T2.0,TAPE WF-724,H		1	S.N.A
4-2	BP63-00013A	COVER-DECO,LED;507W,ABS HB,BLK		1	S.N.A
4-3	BP64-00071A	INDICATOR LED;507W,ACRYL		1	S.N.A
4-4	BP63-00012A	COVER-GRILLE;507W,HIPS,HB,GRAY		1	S.N.A
4-5	AA61-00206A	MAGNET-GRILLE;43J6,PI15X3T,-,-,-,-		4	S.N.A
4-6	AA61-00650B	HOLDER-MAGNET, TOP;50L2,ABS,HB,G3676		4	S.N.A
5-1	AA64-02831A	CABINET-BACK, BOT;507W,HIPS,VO,GRY,G4309		1	
5-2	AA61-10379B	BRACKET-COVER;SP43J6,SECC-1,T1.0,-,-,-,-		1	S.N.A
5-3	AA61-01201A	BRACKET-DUCT,OUT;507W,SECC-1,T0.8,BLK		1	S.N.A
5-4	AA63-00598A	COVER-LAMP;507W,HIPS,VO,GRY,G4309		1	S.N.A
6-1	BP91-00791A	ASSY MISC-ENGINE SVC;43504656 SVC ASS		1	S.N.A